

WB6 & WB8 Rough In Wall Bracket Installation Guide

The function of this bracket is to fix the speaker location prior to the wallboard being installed. To best utilize this bracket, follow these simple steps.

Procedure:

1. Determine the location of the speaker. That location will dictate where the wings attach to the bracket, see Figure 1.

In some applications, you may need to use the wire loop to fasten the bracket to framing support, see Figure 2

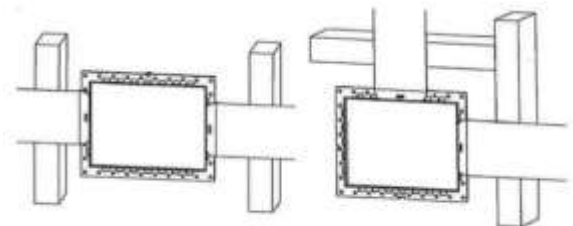

Figure 1

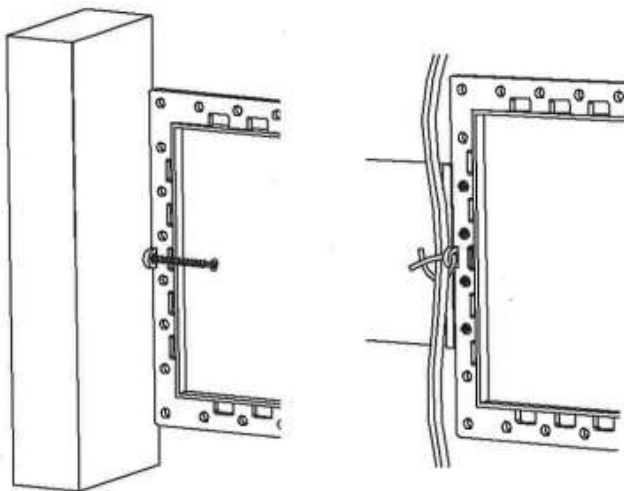

Figure 2

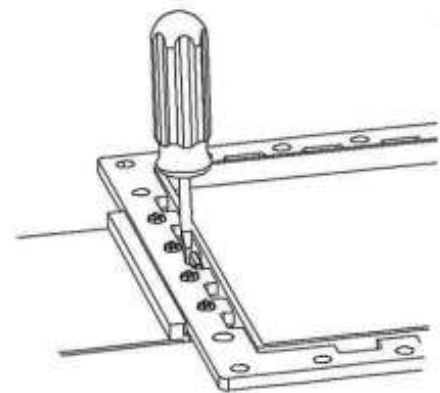

Figure 3

NOTE: If you need to reposition the wings to the bracket, see Figure 3

2. When fastening the wings to the framing supports, be sure the screws/nails are flush with the surface so as not to bow the wallboard

About HARMAN Professional Solutions

HARMAN Professional Solutions is the world's largest professional audio, video, lighting, and control products and systems company. Our brands comprise AKG Acoustics®, AMX®, BSS Audio®, Crown International®, dbx Professional®, DigiTech®, JBL Professional®, Lexicon Pro®, Martin®, Soundcraft® and Studer®. These best-in-class products are designed, manufactured and delivered to a variety of customers in markets including tour, cinema and retail as well as corporate, government, education, large venue and hospitality. For scalable, high-impact communication and entertainment systems, HARMAN Professional Solutions is your single point of contact. www.harmanpro.com