

v1.0

How to set Static IP address in Windows 11

09-Apr-21

Windows 11 Ethernet Static settings

To set a static IP address configuration to an Ethernet adapter, use these steps:

1. Open **Settings**.
2. Click on **Network & internet**.
3. Click the **Ethernet** page on the right side.

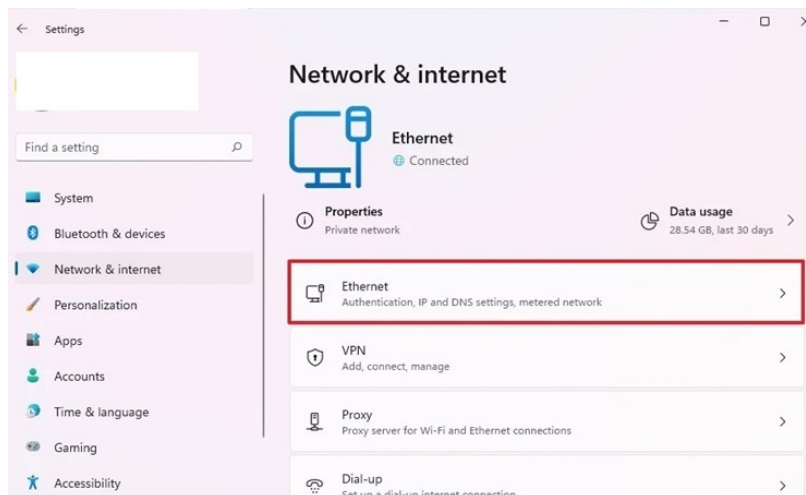

4. Click the **Edit** button for IP Assignment:

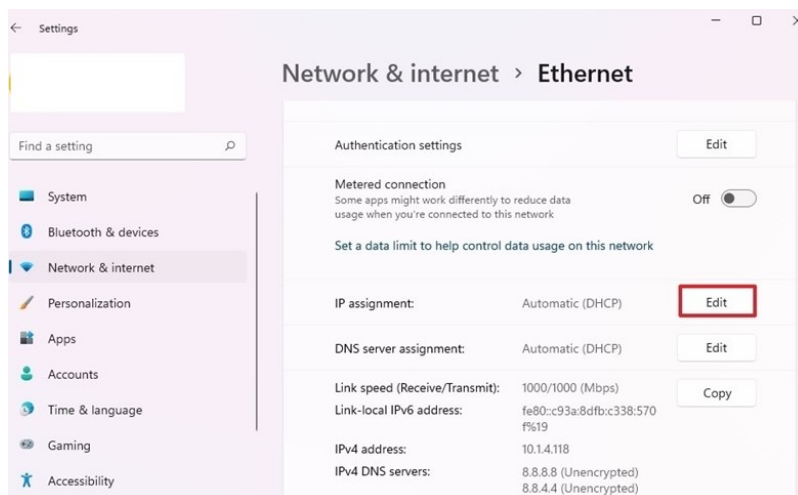

How to set Static IP address in Windows 11



5. Select the **Manual** option.
6. Turn on the **IPv4** toggle switch.
7. In the **IP address** setting, specify the IP address to assign to the computer.

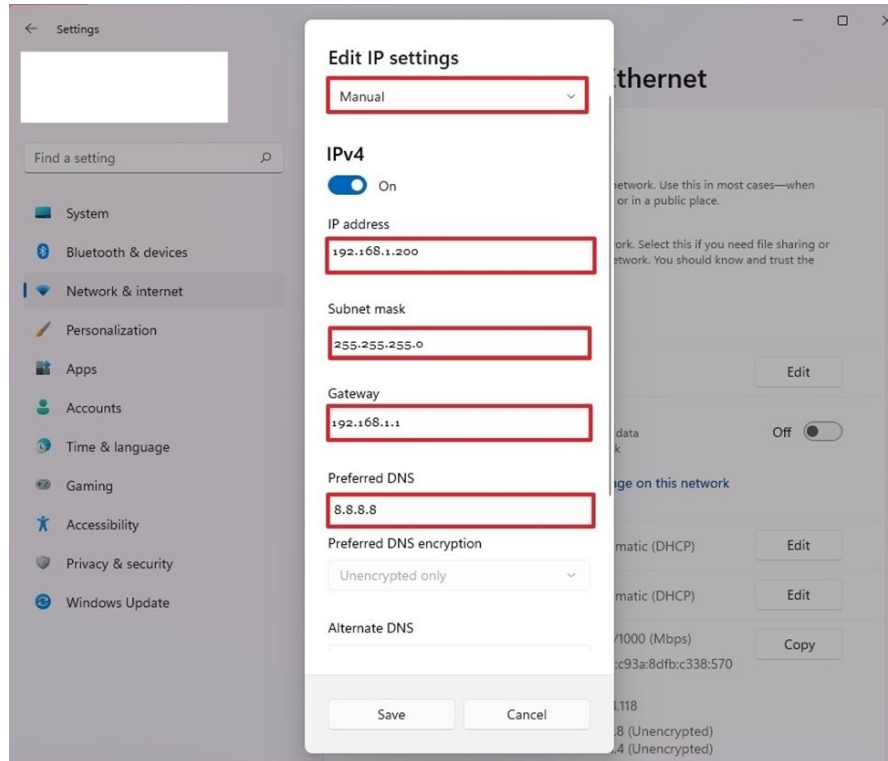

Quick tip: The IP address should be within the network range, and it should be outside of the DHCP scope to avoid possible conflicts. For instance, if the network is in the **192.168.1.x** range and the DHCP assigns an address from **192.168.1.2** through **192.168.1.199** (one of the most common default router settings), a suitable static address could be **192.168.1.200**.

8. In the **Subnet mask** setting, specify the network mask — for example, **255.255.255.0**.

Quick note: If you are configuring the settings on a home or office network, the subnet mask is typically **255.255.255.0**. However, it might be different if you are in a business environment,

9. In the **Gateway** setting, specify the gateway address (usually the router address) — for example, **192.168.1.1**.
10. In the **Preferred DNS** setting, specify the network DNS address (I use Google Public DNS even though the mixer will never require DNS) – for example, **8.8.8.8**.

How to set Static IP address in Windows 11



11. In the **Preferred DNS** encryption setting, select the **Unencrypted only** option.
12. In the **Alternate DNS** setting, specify a secondary DNS address that will be used in case the system can't find the correct route with the primary address. This must be unique. A good choice could be 8.8.4.4 , which is Google's Public DNS Alternate.
13. In the **Alternate DNS encryption** setting, select the **Unencrypted only** option.
14. Click the **Save** button.

After you complete the steps, the computer will start using the new static network configuration.

About HARMAN Professional Solutions

HARMAN Professional Solutions is the world's largest professional audio, video, lighting, and control products and systems company. Our brands comprise AKG Acoustics®, AMX®, BSS Audio®, Crown International®, dbx Professional®, DigiTech®, JBL Professional®, Lexicon Pro®, Martin®, and Soundcraft®. These best-in-class products are designed, manufactured and delivered to a variety of customers in markets including tour, cinema and retail as well as corporate, government, education, large venue and hospitality. For scalable, high-impact communication and entertainment systems, HARMAN Professional Solutions is your single point of contact. www.harman.com

